

ZANUSSI

16" METAL STAND FAN

ITEM NO. : ZF-1616C/1616W



Instruction Manual

Please keep for future reference

Thank you for purchasing 16" Metal Stand Fan

SAFETY GUIDELINES

1. Read the instructions carefully since they give important indications concerning safety guidelines, assembly, operation, cleaning and care.
2. Check the condition of the appliance after removing from the packaging. Ensure that all component parts of the fan are within the packaging and have not been damaged.
3. Never leave any parts of the packing within reach of children.
4. This appliance must only be used for the purpose for which it was designed i.e. for room ventilation. **DO NOT USE IN BATHROOMS.**
5. Never insert objects into the grille of the fan.
6. Never touch the appliance with wet or damp hands.
7. Never pull the cable or the appliance itself in order to disconnect the plug from the socket.
8. Before carrying out any cleaning or servicing operation always remove the plug from the socket.
9. In the event of appliance failing to operate, all repairing work must be undertaken by a qualified engineer.
10. If the supply cord is damaged, it must be replaced by the manufacturer, its service agent or similarly qualified persons in order to avoid a hazard.
11. Ensure that the fan is switched off from the supply mains before removing the guard.
12. The appliance is not intended for use by persons (including children) with reduced physical, sensory or mental capabilities, or lack of experience and knowledge, unless they have been given supervision or instruction.

Warning : Never use without the guards in place!

ASSEMBLY

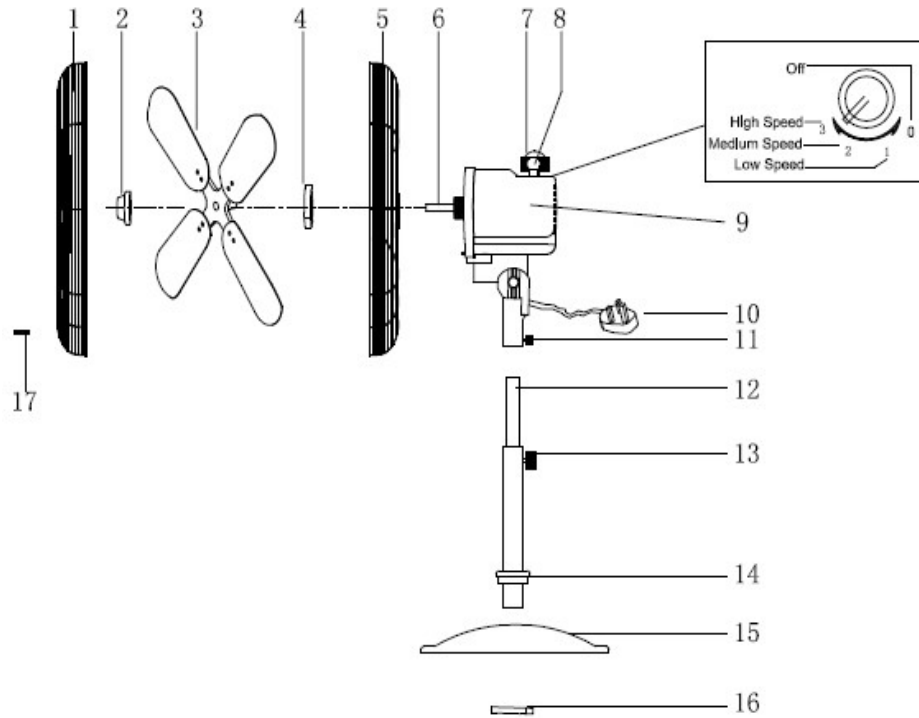

- | | |
|----------------------|-----------------------|
| 1. Front grille | 10. Power cord & plug |
| 2. Blade locking cap | 11. Fixing screw A |
| 3. Blade | 12. Upper pillar |
| 4. Guard knob | 13. Fixing screw B |
| 5. Rear grille | 14. Main pillar |
| 6. Motor shaft | 15. Base |
| 7. Rotary switch | 16. Pole fixing nut |
| 8. Oscillating knob | 17. Safety screw |
| 9. Motor housing | |

- Carefully unpack the appliance and remove all the packaging materials attached to your Fan. Pick out the base (15) and the pole sets (12~14), remove the pole fixing nut (16) from the Main pillar (14) and insert the Main pillar into the hole of the Base then tighten the Pole fixing nut (16).

- Release Fixing screw B (13) and adjust height to suitable length. Re-tighten the Fixing screw B (13) once ready.

- Release the Fixing screw A (11), connect the Motor housing (9) with the Upper pillar (12), fasten it with the Fixing screw A (11).

- Remove the Blade locking cap (2) and the Guard knob (4) from the Motor shaft (6), secure the Rear grille (5) on the Motor housing (9) to match with the three fixing pins, fasten the grille with Guard knob (4).

- Put the Blade (3) on the Motor shaft (6) and tighten it with Blade locking cap (2).

- Put the Front grille (1) onto the Rear grille (5), settle it by the guard fixing clip then fasten it with the Safety screw (17).

OPERATION

Unwind the power cable and Position the unit on a level, dry and flat surface where the air outlet grilles cannot be obstructed. Position the appliance at least 30 cm away from walls or obstacles.

Connect and ensure that the plug and the socket fit well.

Select the desired speed setting by rotating the Rotary switch. There are 3 speeds : 0 (Off), 1 (Low Speed), 2 (Medium Speed), 3 (High Speed)

Push the Oscillating knob (8) for oscillation and pull the Oscillating knob (8) for fixed position.

The airflow can be adjusted upward or downward by simply moving the Motor housing (9) up or down.

Warning : Never touch the Blade with your hand or any other objects when the Fan is operating.

CLEANING AND CARE

Always disconnect the fan from mains socket before cleaning.

Avoid contact with moving fan parts.

Use only a soft damp cloth to clean the fan.

DO NOT immerse the fan in water and never allow water to drip into the Motor housing.

Never spray the appliance with liquids or submerge it in water or other liquid.

DO NOT use harsh or abrasive chemicals to clean the fan. Never use polish or any corrosive liquid that will damage the paint, metal or plastic.

Ensure that the fan is switched off from the mains socket before removing.

Store the fan in its original box or cover the fan to protect it from dust in a dry place if it will not be used for a long period of time.

Note : If the cordset of this appliance becomes damaged, discontinue use. Repairs should be undertaken only by a qualified technician.

TECHNICAL SPECIFICATIONS

Item No. : ZF-1616C/1616W
Voltage : AC 220-240V~ 50Hz
Wattage : 60W
Product size : 45 x 41 x 90/125 cm
N. W. : 5.6 kg

**** Please keep and present purchase invoice for repair or inspection. The guarantee does not cover the damage caused by accident, alteration or repair by any unauthorized persons.**

HONG KONG SERVICE CENTRE :
DAH CHONG HONG, LTD
Electrical Appliances Service Centre
Tel: 3193 9888