

ZANUSSI

8" DC DESK FAN

ITEM NO. : DC-208

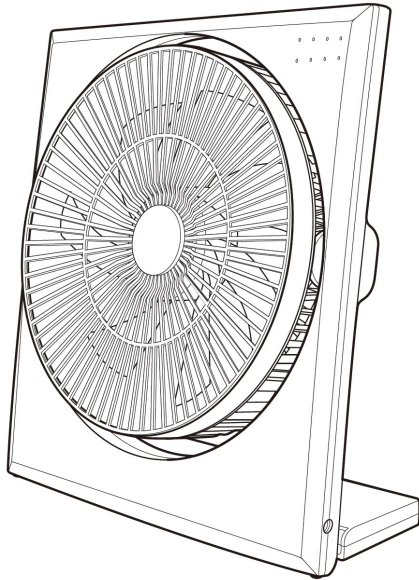

Instruction Manual

Please keep for future reference

Thank you for purchasing 8" DC Desk Fan

SAFETY GUIDELINES

1. Read the instructions carefully since they give important indications concerning safety guidelines, assembly, operation, cleaning and care.
2. Check the condition of the appliance after removing from the packaging. Ensure that all component parts of the fan are within the packaging and have not been damaged.
3. Never leave any parts of the packing within reach of children.
4. This appliance must only be used for the purpose for which it was designed i.e. for room ventilation. **DO NOT USE IN BATHROOMS.**
5. Never insert objects into the grille of the fan.
6. Never touch the appliance with wet or damp hands.
7. Never pull the cable or the appliance itself in order to disconnect the plug from the socket.
8. Before carrying out any cleaning or servicing operation always remove the plug from the socket.
9. In the event of appliance failing to operate, all repairing work must be undertaken by a qualified engineer.
10. If the supply cord is damaged, it must be replaced by the manufacturer, its service agent or similarly qualified persons in order to avoid a hazard.
11. Ensure that the fan is switched off from the supply mains before removing the guard.
12. The appliance is not intended for use by persons (including children) with reduced physical, sensory or mental capabilities, or lack of experience and knowledge, unless they have been given supervision or instruction.

Warning : Never use without the guards in place!

Parts

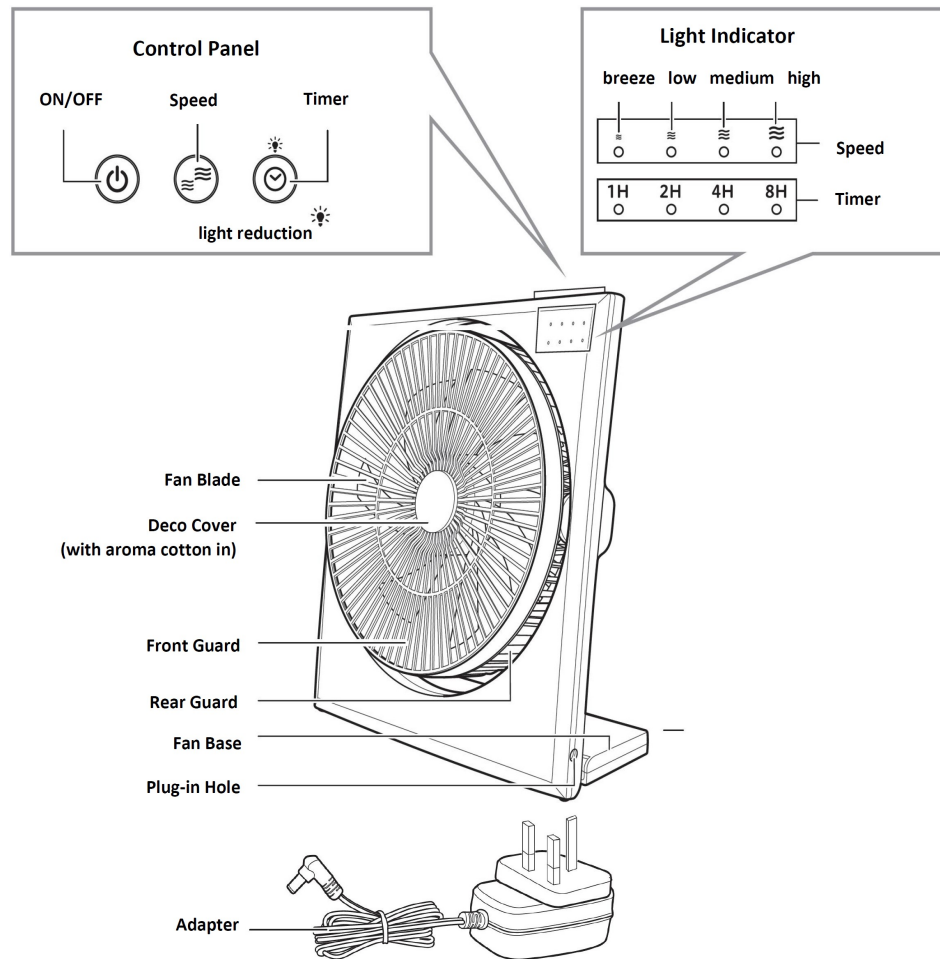

OPERATION

Remove all the package, take out the product and the adapter. Connect the out-put terminal with the plug-in hole at the side of the product, then plug in the adapter into the socket. This product is ready to operate.

◆ ON/OFF

Find the control panel at the top of the product, press the ON/OFF button one time, the fan will be ON and again to stop it.

◆ Speed

This product have 4 speeds: breeze, low, medium, high. Each speed will be showing with the related light indicator while the fan running. Consumer can select the suitable speed according to their own preferences.

◆ Timer

This product have 4 timers:1H,2H,4H,8H.Each timer will be showing with the related light indicator while the fan running. Consumer can select the suitable timer according to their own preferences. The fan will be stopped once the selected timer over.

◆ Tilting

This product can be adjusted the airflow while move the fan head upward or downward manually.

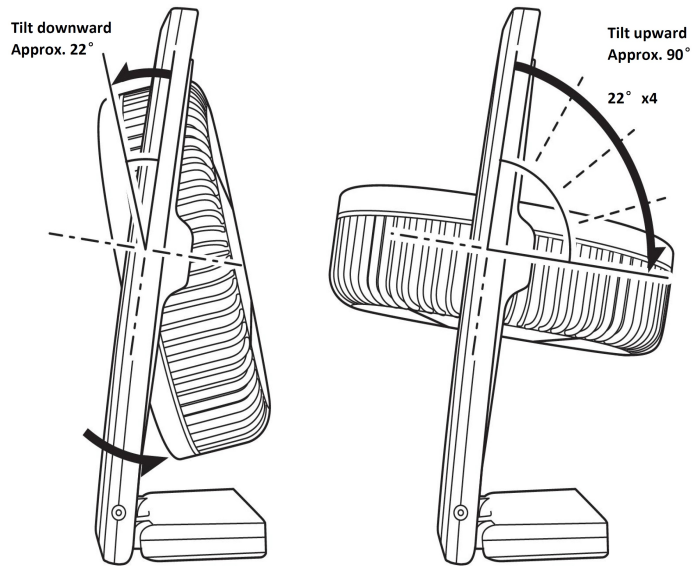

◆ Aroma

There has an aroma cotton in the decoration cover, the consumers can make their own decision whether to add the flavor or replace the aroma cotton after used.

Below the steps for your reference:

- ① Press the front guard, rotate the decoration cover anti-clockwise then remove it down.
- ② Rotate the decoration cover anti-clockwise again to open the aroma cover, add the flavor on the cotton then cover it.
- ③ This aroma cotton can be changed to a new one after long time used.

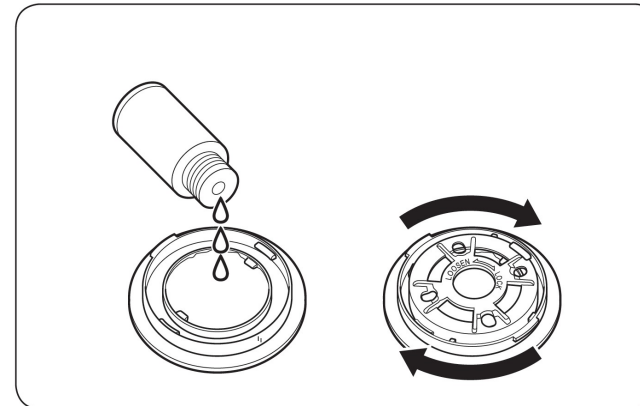
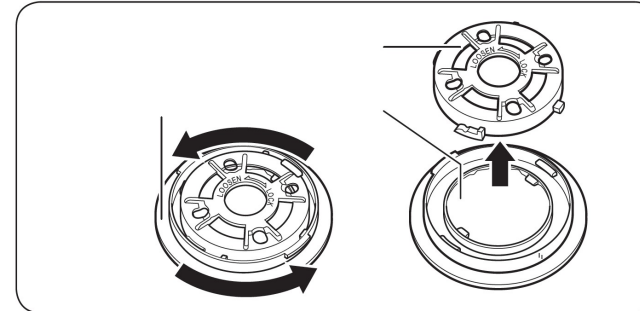
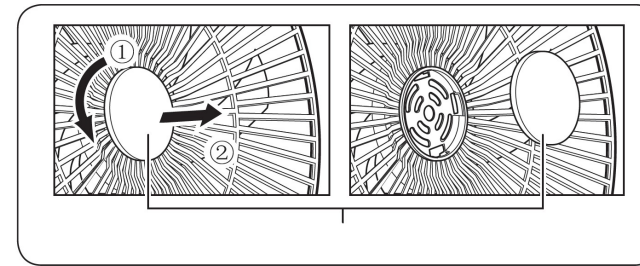

Cleaning & Care

Always disconnect the fan from mains socket before cleaning.

Remove the front guard, blade cap and fan blade in turn. Please pay attention to the two reference position while rotate the front guard, you can remove the guard only if the position 1 & 2 match together. Use only a soft damp cloth to clean the fan. Never spray the appliance with liquids or submerge it in water or other liquid.

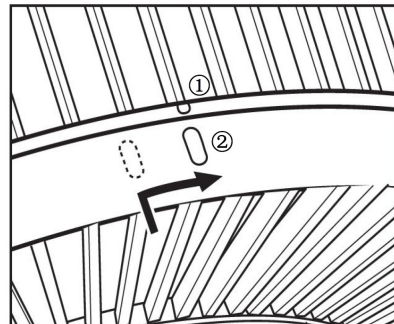
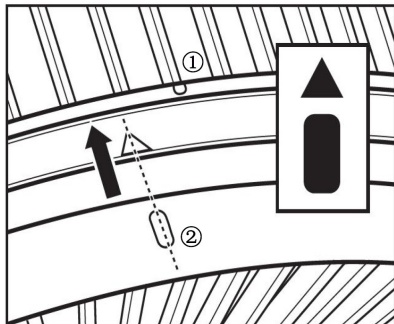
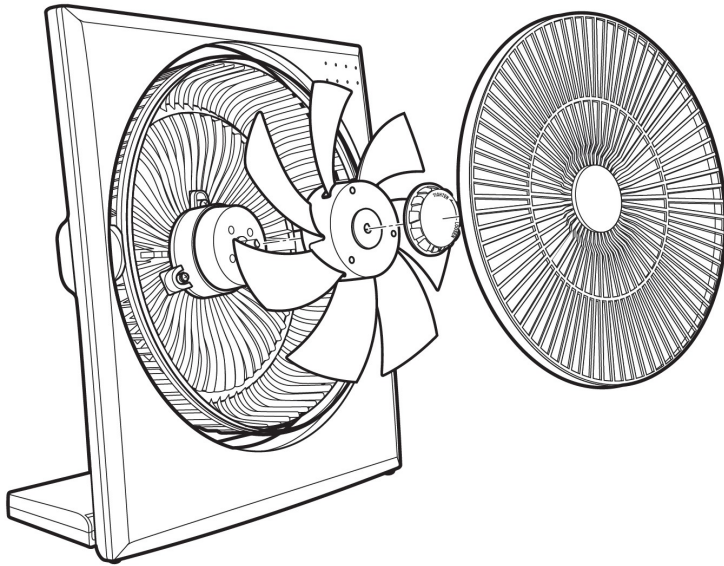

Store the fan in its original box or cover the fan to protect it from dust in a dry place if it will not be used for a long period of time.

Note : If the cordset of this appliance becomes damaged, discontinue use. Repairs should be undertaken only by a qualified technician.

TECHNICAL SPECIFICATIONS

Item No. : DC-208
Adapter Voltage : AC 100-240V~ 50/60Hz
Wattage : DC24V 6W
Product size : 30.6 x 27.6 x 11.5 cm
N. W. : 1.13 kg

**** Please keep and present purchase invoice for repair or inspection.
The guarantee does not cover the damage caused by accident,
alteration or repair by any unauthorized persons.**

HONG KONG SERVICE CENTRE :
DAH CHONG HONG, LTD
Electrical Appliances Service Centre
Tel: 3193 9888